

## PRINTABLE INFO SHEET

**Series: Cambridge 2 Ranch  
Collection  
Model: HX307A Beechwood**



## About This Model

**Style: Ranch / Bedrooms: 3 / Bathrooms: 2 / Square Feet: 1352**

## CUSTOMER CONTACT

Notes:

---

---

---

---

# PRINTABLE INFO SHEET

Series: Cambridge 2 Ranch  
 Collection  
 Model: HX307A Beechwood



## Floorplan

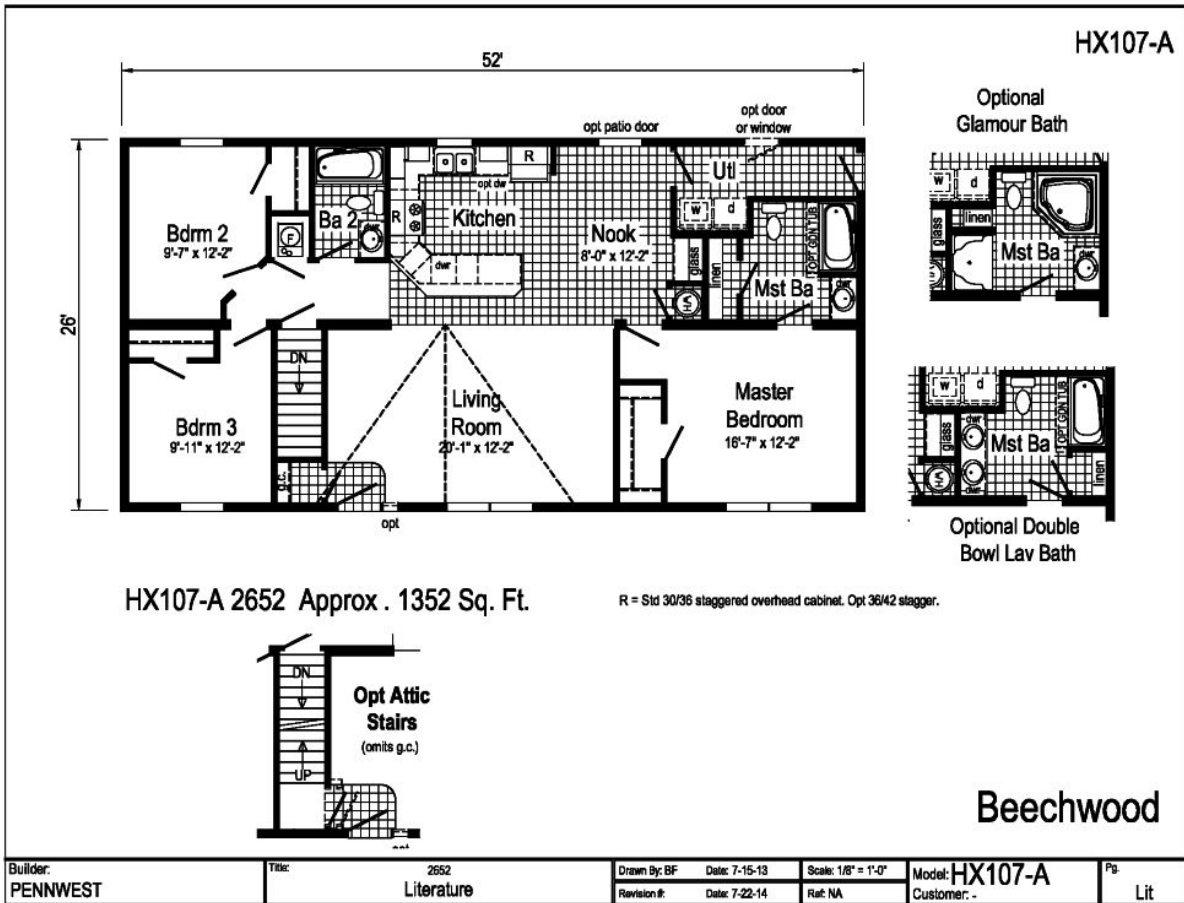

## CUSTOMER CONTACT

Notes: \_\_\_\_\_

\_\_\_\_\_

\_\_\_\_\_

\_\_\_\_\_

# PRINTABLE INFO SHEET

Series: Cambridge 2 Ranch  
 Collection  
 Model: HX307A Beechwood



## Floorplan

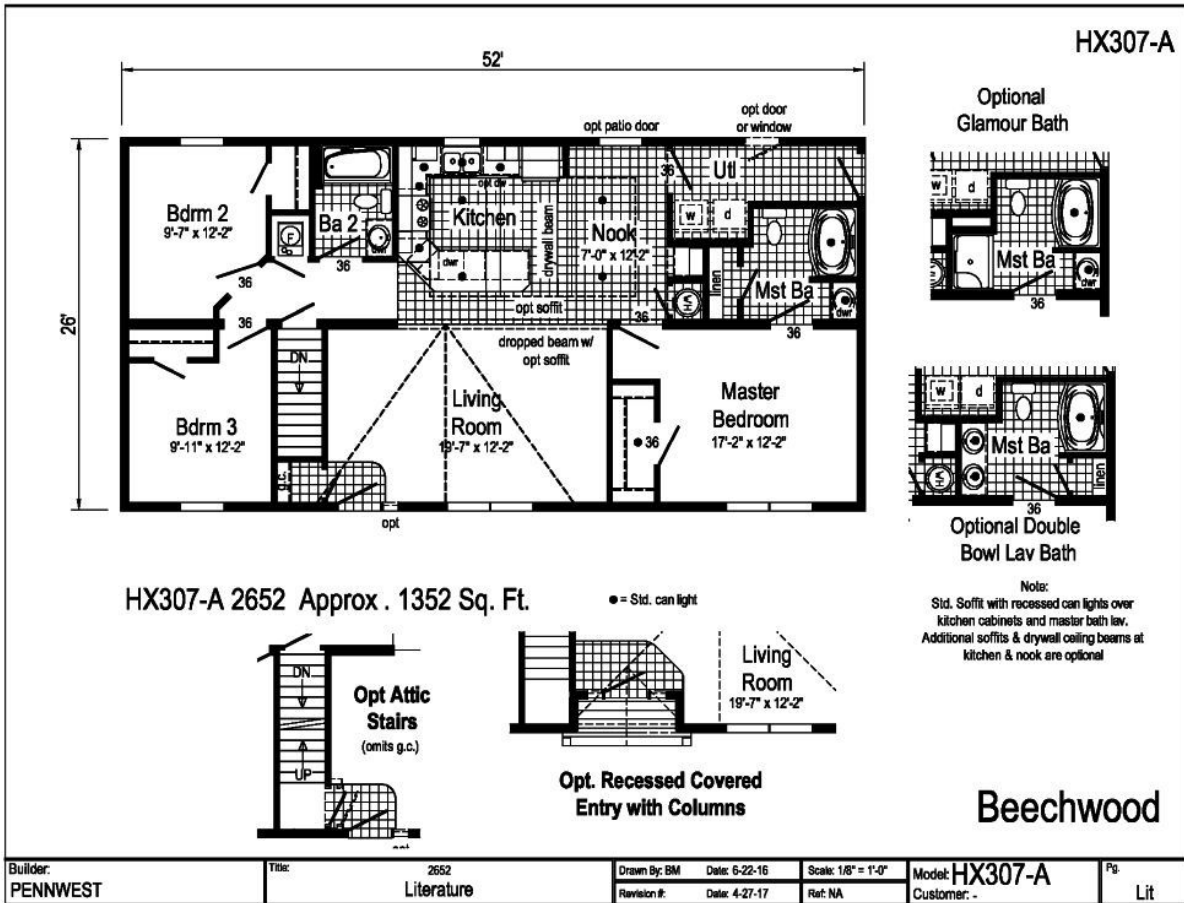

## CUSTOMER CONTACT

Notes: \_\_\_\_\_

\_\_\_\_\_

\_\_\_\_\_

\_\_\_\_\_

# PRINTABLE INFO SHEET

**Series: Cambridge 2 Ranch  
Collection  
Model: HX307A Beechwood**



## Standards & Features

### HOME COMPONENTS

- Complete Water Lines Supplied
- Complete Electrical
- Drain and Gas Lines Stubbed Through Floor
- Complete Heat System
- Complete Air Return System

### INTERIOR

- Primed Drywall Throughout
- Smooth Flat Ceiling Throughout
- 8'0" Ceiling Height
- Mantra or It's Cozy Carpet
- Rebond Carpet Pad
- Tackstrip Carpet Installation
- Foyer Entry with Vinyl Flooring
- No-Wax Vinyl Floor Coverings by Congoleum
- Brushed Nickel Pendant Dining Room Light
- 2 Recessed LED Lights in Nook
- 36" Doors - where available
- Pre-Hung Doors with Mortise Hinges
- Metal Interior Passage Sets
- Smoke Detectors with Battery Back-Up
- Wire Shelving in Guest Closet
- White Painted Pine Moldings Throughout

White 6-Panel

### KITCHEN

Tip-Out Trays at Sink

### KITCHEN (continued)

- Stainless Steel Sink-33x22x8
- Huntington Brass Brushed Nickel Single Lever Faucet
- Power Range Hood with Light
- 30" Deluxe Gas Range
- 18 Cu. Ft. Frost Free Refrigerator
- 1 USB Receptacle
- Sweep-O-Vac in Island or Base Cabinet

### CABINETRY

- Evermore Custom Cabinetry (KCMA Certified)
- Choice of Oak or Barnwood Oak 3/4 Overlay

Mission Flat

- Panel Cabinet Doors
- Hardwood Oak Cabinet Face Frames
- Upgrade Cabinet Hardware
- Hidden Cabinet Hinges
- 30" Wall Cabinets with 6" Wood Trim & Crown
- 6" x 27" Soffit with 5 Recessed LED Lights Above Cab.
- Adjustable Shelves in Overhead Cabinets
- Drawer-Over-Door Base Cabinets
- 100# Undermount Drawer Guides
- Base and Center Shelves in Base Cabinets
- Dovetail Drawer Construction
- Laminate Countertops with Laminate Edging

## CUSTOMER CONTACT

Notes:

---



---



---



---

# PRINTABLE INFO SHEET

**Series: Cambridge 2 Ranch  
Collection  
Model: HX307A Beechwood**



## Standards & Features (continued)

### CABINETRY (continued)

4" Laminate Backsplash  
Kitchen Island &ndash; Where Available  
36" High Vanities

### BATHS

Curved Front Garden Tub in Master  
Bath - Where Available  
Tub Overflows  
Recessed LED Light over Tub in  
Master Bath  
Elongated Toilets  
China Sinks with Overflows and  
Pop-Up Drains  
Lighted Vent Fan in Each Bath  
Soffit over Master Vanity with Recessed LED Lights  
Huntington Brass Brushed Nickel Faucets  
Anti-Scald Valves on Showers and Tubs  
Linens - Where Available

### UTILITIES

200 AMP Electrical Service  
Plumb and Wire for Washer  
Wire for Dryer  
Programmable Thermostat with  
8-Wires  
Main Water Line Shut-Off Valve  
Water Shut-Off Valves where  
Accessible  
One Exterior Water Faucet  
50 Gallon Electric Water Heater with Pan  
Energy Efficient 90 Plus Gas Furnace  
Perimeter Heat System with Fiberglass

### UTILITIES (continued)

Heat Ducts

### BEDROOMS

Switched Recepts  
Egress Window Each Bedroom  
Wire Shelving in Wardrobes  
Switched 4" Recessed LED Light

in All Walk-In

Closets

### INSULATION

R-19 Fiberglass Insulation in Walls  
R-38 Avg. Batt Insulation in Ceiling

### EXTERIOR

Pantina Lantern Light at Front and Rear Door  
Two GFI-Protected Exterior Receptacles  
Vinyl Ship Lap Siding  
O.S.B. Sheathing Under Siding  
Wind Wrap Air Infiltration Barrier  
5/12 Pitch Roof with 12" Eaves and Overhangs  
Architectural Shingles  
Ridgevent Roof Ventilation System  
Ice Shield  
3/0 x 6/8 Pre-Finished 6-Panel Rear  
Door with Deadbolt Locks  
Painted 6-Panel Front Door in Choice  
of Color with Deadbolt Locks  
Vinyl Insulated Argon Filled Windows with Low-E Glass (No  
Grids)  
Lineals on Front Door Side

### CONSTRUCTION

2x10 Transverse Floor System on

## CUSTOMER CONTACT

Notes:

---

---

---

---

## **PRINTABLE INFO SHEET**

**Series: Cambridge 2 Ranch  
Collection  
Model: HX307A Beechwood**



## **Standards & Features (continued)**

### **CONSTRUCTION (continued)**

16" Centers with 23/32" OSB T&G

Floor Decking\*\*

2x6 Exterior Walls on 16" Centers\*\*

2x4 Interior Walls

90 Mile Exposure C Wind Load Design

40# Roof Load Design

\*\*NOTE: Spacing for Framing Members may vary due to Design Requirements

## **CUSTOMER CONTACT**

Notes:

---

---

---

---